

September 12, 1997  
NESSWD:mc/ko

Introduced By: ERIAN DERDOWSKI

Proposed No.: 97-599

ORDINANCE NO. **12911**

1

2  
3  
4  
5  
6  
7  
8  
9

AN ORDINANCE relating to the annexation and transfer of two separate 5-acre parcels, located in portions of the northeast corner of Section 27, Township 25 North, Range 6 East, known as Annexation 19 to the Northeast Sammamish Sewer and Water District for the purpose of providing water and sewer service.

10

STATEMENT OF FACT:

11  
12  
13  
14  
15  
16  
17  
  
18  
19  
20  
  
21  
22  
23  
24  
  
25  
26  
27  
28  
29  
30  
31  
  
32  
33

1. A notice of intention proposing the annexation of a 5-acre area and transfer of an additional 5-acre area, located in portions of the northeast corner of Section 27, Township 25 North, Range 6 East, known as Annexation 19, to the Northeast Sammamish Sewer and Water District for providing water and sewer service was filed with the County Council effective March 13, 1997.
2. The Northeast Sammamish Sewer and Water District adopted a Determination of Nonsignificance on December 19, 1996 on the proposed annexation.
3. The Northeast Sammamish Sewer and Water District has found the petition for annexation to be sufficient and has, by Resolution No. 2875 concurred with the proposed annexation.
4. The Northeast Sammamish Sewer and Water District has found the petition for district transfer to be sufficient and has by Resolution No. 2848 concurred with the proposed transfer. The Sammamish Plateau Water and Sewer District has by Resolution No. 2070 concurred with the proposed transfer to the Northeast Sammamish Sewer and Water District.
5. The Utilities Technical Review Committee recommended approval of the annexation and transfer in April, 1997.

1 6. The County Council held a public hearing on the day of  
2 November 10, 1997 and has considered the criteria set  
3 forth in R.C.W. 57.02.040 and 57.32.160.

4 BE IT ORDAINED BY THE COUNCIL OF KING COUNTY:

5 SECTION 1. The annexation by and transfer to the  
6 Northeast Sammamish Sewer and Water District of adjoining 5-  
7 acre areas, located in portions of the northeast corner of  
8 Section 27, Township 25 North, Range 6 East, known as  
9 Annexation 19 and described in Attachment A, is approved.  
10 The proposed annexation is consistent with R.C.W. 57.02.040.  
11 The proposed district transfer is consistent with R.C.W.  
12 57.32.160 and R.C.W. 57.02.040.

13 SECTION 2. The Northeast Sammamish Sewer and Water  
14 District is the appropriate entity to serve the areas  
15 proposed to be annexed and transferred.

12911

1            SECTION 3. Completion of this annexation and district  
2 transfer does not constitute County approval or disapproval  
3 of any other permits, certifications, or actions necessary to  
4 provide service to this annexation area.

5  
6            INTRODUCED AND READ for the first time this 6<sup>th</sup>  
7 day of October, 1997.

8            PASSED by a vote of 11 to 0 this 10<sup>th</sup> day of  
9 November, 1997.

10            KING COUNTY COUNCIL  
11            KING COUNTY, WASHINGTON

12  
13            Jane Hague  
14            Chair

15  
16  
17            ATTEST:  
18            [Signature]  
19            Clerk of the Council

20            APPROVED this 19 day of November, 1997.

21  
22            [Signature]  
23            King County Executive

24  
25            Attachments: A. Legal Description  
26                            B. Map

12911

Northeast Sammamish Sewer and Water District  
Cedar Park Annexation and District Transfer  
Legal Description

District Annexation

East ½ of the NE ¼ of the NW ¼ of the NE ¼ of Section 27, Township 25N, Range 6E W.M.

District Transfer

West ½ of the NW ¼ of the NE ¼ of the NE ¼ Of Section 27, Township 25N, Range 6E W.M.

FILE NO. 1991 - NORTHEAST SAMMAMISH SEWER AND WATER DISTRICT - NO. 19 ANNEXATION

12911

URBAN GROWTH BOUNDARY

RECEIVED

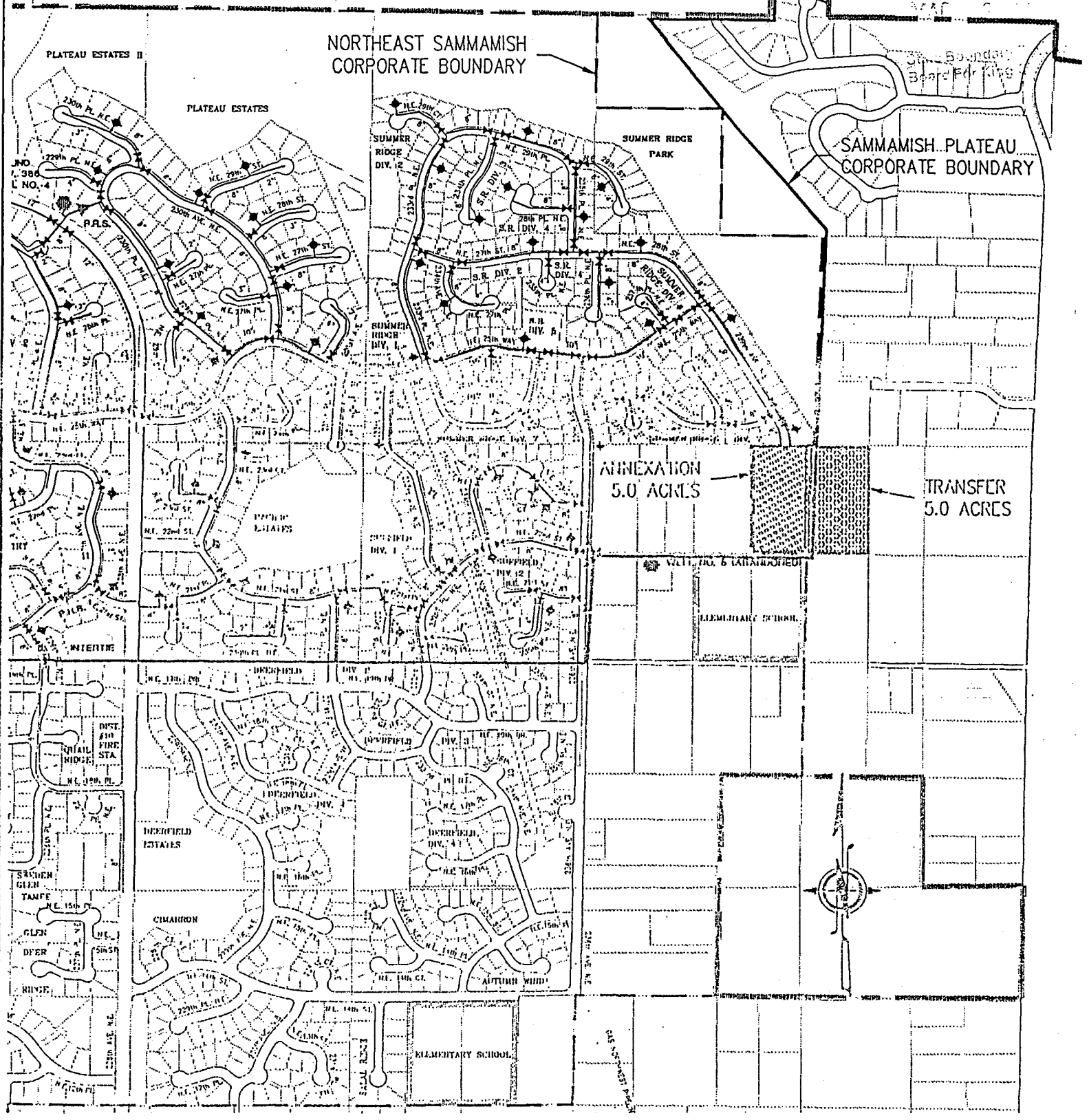

**NORTHEAST SAMMAMISH SEWER AND WATER DISTRICT  
ANNEXATION #19 AND DISTRICT TERRITORY TRANSFER**

1" = 800'